

HOCKEY PUCK™ ANTENNA

AP85/18

Greater Connectivity to Cellular and PCS Networks

The Hockey Puck Antenna™ is the low profile 3 dB gain external antenna for use with Wireless Data Cards for the cellular networks. It is typically used by mobile road warriors (sales, field service, police) who travel extensively, and need connectivity wherever they go.

Bigger Wireless Footprint

The Hockey Puck Antenna™ provides up to 25% more wireless coverage, depending on the geography you travel in.

Faster Data Speeds

Better reception translates to faster speeds. The data gets through the first time, correctly.

Long Product Life – Low Profile Design

The Hockey Puck Antenna™ stands only 1.3 inches high. It withstands all of the natural elements, car washes, and being swept by tree branches.

Small and Portable

The Hockey Puck Antenna™ comes in two styles – magnetic and permanent mount. The magnetic version is perfect for the user who wants to put it on top of their vehicle, and then take it with them when they travel.

Connects to all major brands of wireless data cards!

Wireless Data Cards: Sierra Wireless AirCard 597 Compass USB, AirCard 595, AirCard 597E, AirCard 580, USB Connect Mercury, AirCard 881, USB Connect 881, AirCard 875, AirCard 860; NovAtel S720, S620, V620, USB727, EX720, Ovation U727, V640; Kyocera KPC650; Option GT Max, GT Max Ultra, GT



Max Ultra Express; UM150, UM175, PC5750 (with adapter from Verizon), Sony GC86
Docking Stations: Gamber Johnson, LEDCO, PMT, Panasonic, and Kodiak
Wireless Trunk & Mobile Access Routers: AirLink Raven, Cisco MAR, Junxion, United Associates Rocket, and others.

Extra coverage gained with the Hockey Puck Antenna™



Antenna Plus LLC
9458 E Sunnyside Dr. - Scottsdale, AZ 85260
Phone: 480-657-7354 - Fax: 480-657-0204 - orders@antennaplus.com

ANTENNAPLUS
www.antennaplus.com

Dual-Band Antenna

Electrical Specifications

Frequencies:

F1=824-896 MHz

F2=1850-1995 MHz

VSWR: 1.5:1 or less at resonant point

Gain: 3.0 dB

Radiation Pattern:

OMNI Directional

Hemispherical (GPS)

Polarization:

Vertical

Mechanical Specifications

Radome:

Glass Filled Polypropylene

Cable Length:

15 feet (Adhesive Mount)

10 feet (Magnetic Mount)

Connectors:

SMA is standard or Contact factory for connector options.

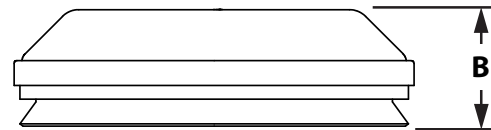
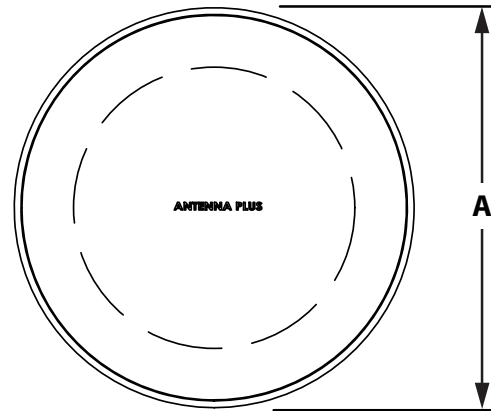

Mount	Adhesive, NMO	Magnet
A	4.4 in.	3.2 in.
B	1.3 in.	1.3 in.